

Convoys Wharf - Thames Path Landscape/Public Realm Strategy

A Thames Path Strategy is being developed to help guide the design of the interface between the riverside plots (P1-P4) and this new and important public open space along the river. The strategy seeks to establish the character, function, look and feel of the public realm landscape to ensure continuity in treatment and the delivery of a high quality riverside promenade which is informed by the legacy of the shipbuilding heritage and the proximity of the river.



A clear and legible route and new links



Green and Blue connections between land and water



Respect and reveal underlying heritage

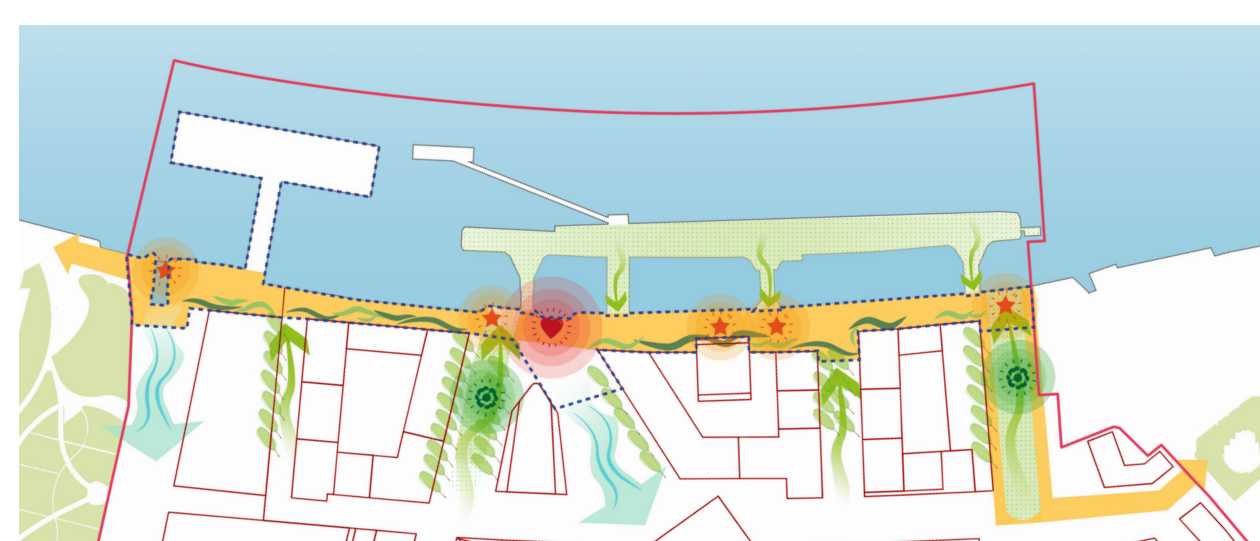

Combined Concept Vision



View across Royal Naval Gardens

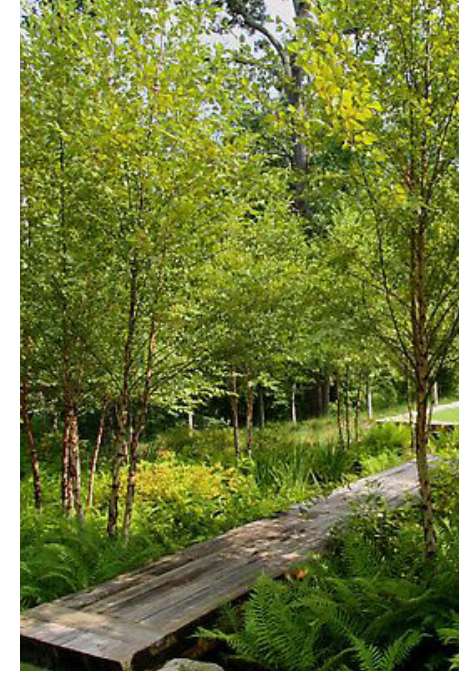
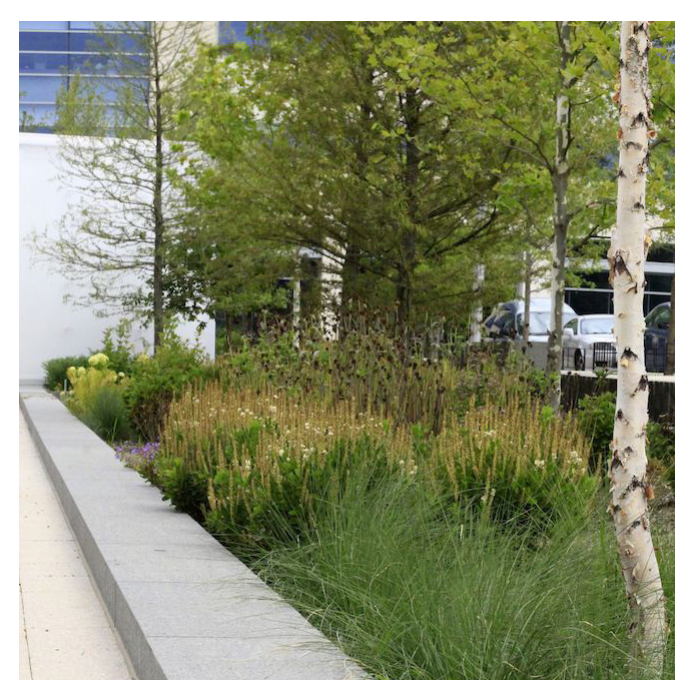

Landscape Materials Palette



Thames Path Masterplan



Section A-A

- 1 **Pepys Park** - new Thames Path connection through existing boundary wall
- 2 **The Wharf** - continuity of the Thames Path through the wharf site
- 3 **Mast Pond Park & Plaza** - potential new green space subject to P21 application
- 4 **Royal Navy Gardens** - extension of sunken garden across the Thames Path to emphasise the notion of a riverside route crossing the historic Slipway
- 5 **Basin Place** - inlet / water feature to define historic 'Central Basin' inlet
- 6 **Historic Slipways 4 & 5** - form and outline defined through the use of surface materials and inlaid text
- 7 **Royal Caroline Square** - extension of green space across Thames Path to reference the underlying form of the historic double dry dock

